

YOUR WORKING AT HEIGHT PARTNER

1800KG ELECTRIC PALLET TRUCK



- Industrial floating stabilizing wheels for maximum stability
- Small size (l2=400mm) and reduced weight (170kg)
- 48V-20Ah removable Li-ion battery with metal protection cover
- Fast charging trough integrated charger
- Turtle button for operation in narrow spaces
- Available in different forks length and width and higher battery capacity

Drive			Electric
Load capacity	Q	kg	1800
Load center distance	c	mm	600
Service weight		kg	170
Length to face of forks	l2	mm	400
Overall width	b1/b2	mm	610/695
Fork dimensions	s/e/l	mm	55/150/1150
Turning radius	Wa	mm	1330
Max. gradeability, laden/unladen		%	6/16
Battery voltage/nominal capacity		V/Ah	48/20



YOUR WORKING AT HEIGHT PARTNER

■ Optimized structure, easy operation

The metal protective cover of the battery can be flipped open and closed.

This simple cover allows for better security and reduces the chance of the battery becoming unplugged accidentally.



■ Safe

The truck uses the second generation drive technology and brushless DC motor. There is no need to replace the carbon brush and the drive is more powerful.

Its max. Gradeability can reach 10% with the load of 1300kg.



■ New plug-in&out battery design

On-board charger with plug-in&out battery to satisfy different working condition.

Fast charging can be optionally equipped with.

Li-ion battery is equipped with CAN and BMS, which is more convenient to use.



■ Rigorous design and convenient maintenance

Floating battery cartridge to protect battery contact pins.

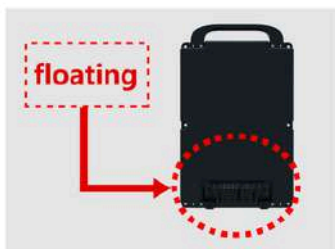

YOUR WORKING AT HEIGHT PARTNER

Distinguishing mark	Drive unit			Electric
	Operator type			Pedestrian
	Rated capacity	Q	kg	1800
	Load center distance	c	mm	800
	Load distance, centre of drive axle to fork	x	mm	940
Service weight	Wheelbase	y	mm	1200
	Service weight		kg	170
	Axle loading, laden front/rear		kg	640/1330
Tyres/class	Axle loading, unladen front/rear		kg	130/40
	Tyre type			Polyurethane
	Tyre size, front		mm	Φ 210x70
	Tyre size, rear		mm	Φ 80x60(Φ 74x88)
	Additional wheels		mm	Φ 74x30
Dimensions	Wheels, number front/rear (x=drive wheels)		mm	1x, 2/4(1x, 2/2)
	Tread, front	b10	mm	450
	Tread, rear	b11	mm	390/(535)
	Lift height	h3	mm	115
	Height drawbar in driving position min./max.	h14	mm	650/1170
	Lowered height	h13	mm	80
	Overall length	l1	mm	1550
	Length to face of forks	l2	mm	400
	Overall width	b1/b2	mm	610(695)
	Fork dimensions	s/e/l	mm	50x150x1150
	Distance between fork-arms	b5	mm	540(685)
	Ground clearance, center of wheelbase	m2	mm	30
	Aisle width for pallets 1000×1200 crossways	Ast	mm	2094
Performance data	Aisle width for pallets 800×1200 crossways	Ast	mm	2146
	Turning radius	Wa	mm	1330
	Travel speed, laden/unladen		km/h	5/5.5
	Lifting speed, laden/unladen		m/s	0.020/0.025
	Lowering speed, laden/unladen		m/s	0.065/0.030
Electric-engine	Max. gradeability, laden/unladen		%	6/16
	Service brake			Electromagnetic
	Drive motor rating S2 60 min		kW	0.9
	Lift motor rating at S3 15%		kW	0.8
Addition data	Battery voltage/nominal capacity		V/Ah	48/20 (30 option)
	Battery weight		kg	14
	Type of drive unit			DC
	Steering design			Mechanical
	Sound pressure level at the driver's ear		dB(A)	74

If there are improvements of technical parameters or configurations, no further notice will be given.
The diagram shown may contain non-standard configurations.

YOUR WORKING AT HEIGHT PARTNER

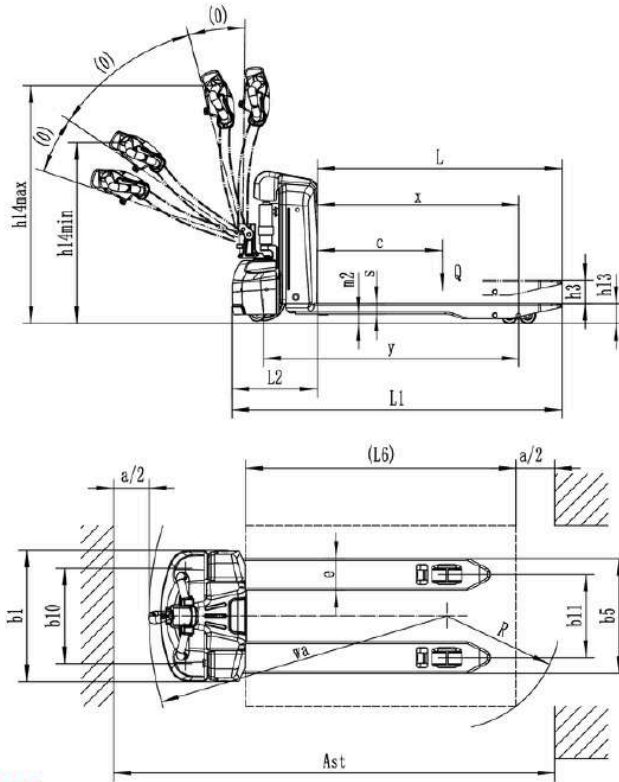

Option:

1.1	Fork dimension	<ul style="list-style-type: none"> •540*1150 ◊540*900, 1000, 1220, 1300, 1400, 1500 ◊685*900, 1000, 1150, 1220, 1300, 1400, 1500
1.3	Fork lowered height	•80
1.5	Load backrest height	◊1220mm (48in) ◊1520mm (60in)
1.6	Drive cover ground clearance	•50mm
2.1	Load wheel type	•Double◊Single
2.2	Load wheel material	•PU
2.3	Drive wheel material	•PU
2.7	Battery capacity	•20Ah◊30Ah
2.8	Charger	•48V-10A integrated◊48V-10A external
2.9	Battery indicator	•With hourmeter
3.3	Caster wheels	•Yes and not customized◊No
3.16	Vertical handle Creep speed	• Yes and not customized

Note: •Standard ◊ Optional - Inconformity